



MAHAAVIR HEIGHTS

Plot No.18, Sector-17, Roadpali.

Luxurious Residential Towers with Exclusive 1 BHK & 2 BHK flats

1 BHK Flat Layout Plan



2BHK Flat Layout Plan



Typical Even Floor Plans

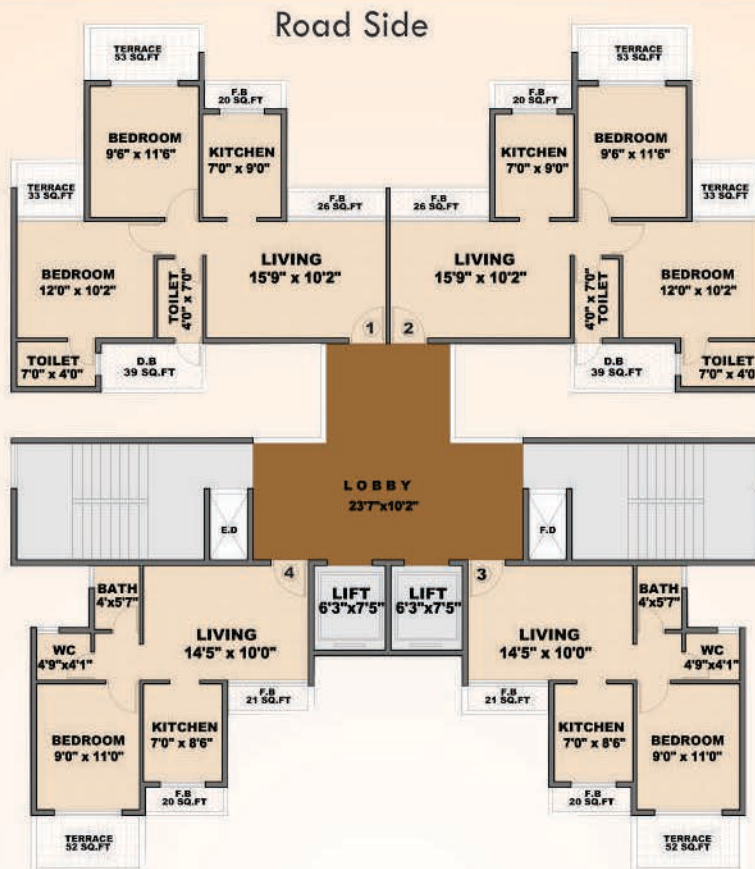

Typical Odd Floor Plans

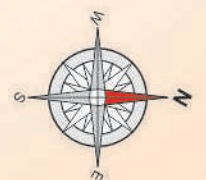
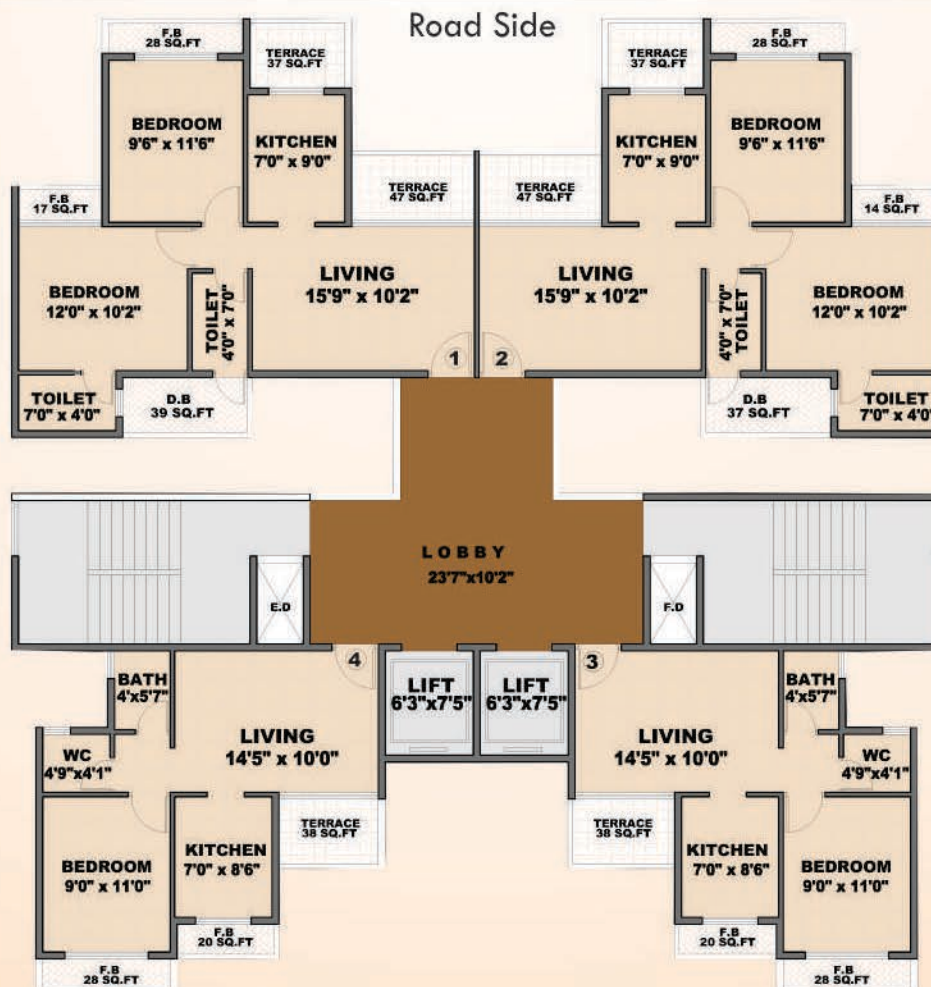

Location Map



MAHAAVIR HEIGHTS
Plot No. 16, Sector-17,
Roadpali, Navimumbai.

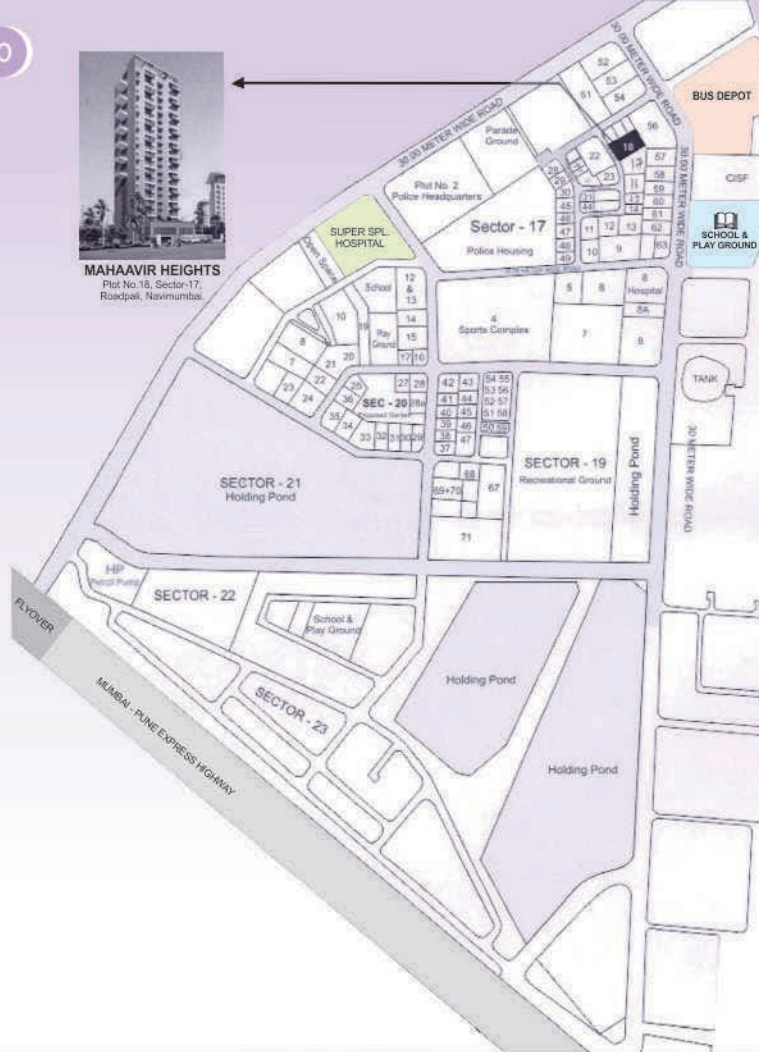

Project Advantages and Features

- Attractive Elevation.
- Decorative A.C. Entrance Lobby.
- Earthquake resistant RCC Structure.
- External Paint with Pure Acrylic Paint.
- Backup Generators for Elevators & Common area Lightings.
- Reputed make HI SPEED automatic Passenger Lifts
- Rain water harvesting.
- Vitrified flooring (800 * 800) in all Rooms of reputed make.
- Concealed wiring with ample Electrical points & modular switches.
- Concealed wiring for inverter in all rooms.
- Video door security system in each flat with cameras at security cabin & Main door with intercom facility.
- Solid laminated flush doors in every room with elegant hardware fittings.
- Aluminum Powder Coated sliding windows with reflective glass.
- All internal walls with POP finish.
- All internal walls painted with Plastic Paint.

In Kitchen

- Granite Kitchen Platform with Service Platform & S.S. Sink.
- Designer Tiles up to Door Level.
- Exhaust Fan.

Bathrooms

- Designer Tiles up to Door Level.
- Jaguar Brand or equivalent C.P. Fittings.
- Branded sanitary wares.
- Exhaust Fans.

Club House

Landscape Area - Roof Top Garden



Corp. Off.: MAHAAVIR UNIVERSAL HOMES PVT. LTD. 66, Mahavir Center, Plot No. 77, Sec.-17, Vashi, Navi Mumbai - 400 703.

Tel.: 022-4157 2600 (100 Lines) | E-mail: sales@mahaavir.com, enquiry@mahaavir.com | Web.: www.mahaavir.com | SMS "MH" to 57007

Disclaimer: All plans, drawings, amenities, facilities etc. are subject to the approval of the respective authorities and would be changed, if necessary. Discretion remains with the developers. All rendering and maps are artists' conception and not actual depictions. This is not an offer document.